

Photograph 51: The Intermingling of Artistry and Technology

Jordan House, Undergraduate Researcher
Department of Theatre- College of Art & Letters

Assistant Scene Design- A.D. Players at the George Theater
The Intermingling of Artistry and Technology

Project Background

- ❖ *Photograph 51* produced by the A.D. Players at The George Theater in Houston, Texas (postponed due to the COVID-19 pandemic)
- ❖ The play surrounds the life of Rosalind Franklin, the often-overlooked x-ray crystallographer whose work was central in discovering the double-helix structure of DNA
- ❖ Served as assistant scene designer to Professor Kirk Domer in a professional regional theater
- ❖ Worked virtually with the Scenic Designer, collaborating with industry professionals in Houston and Dallas

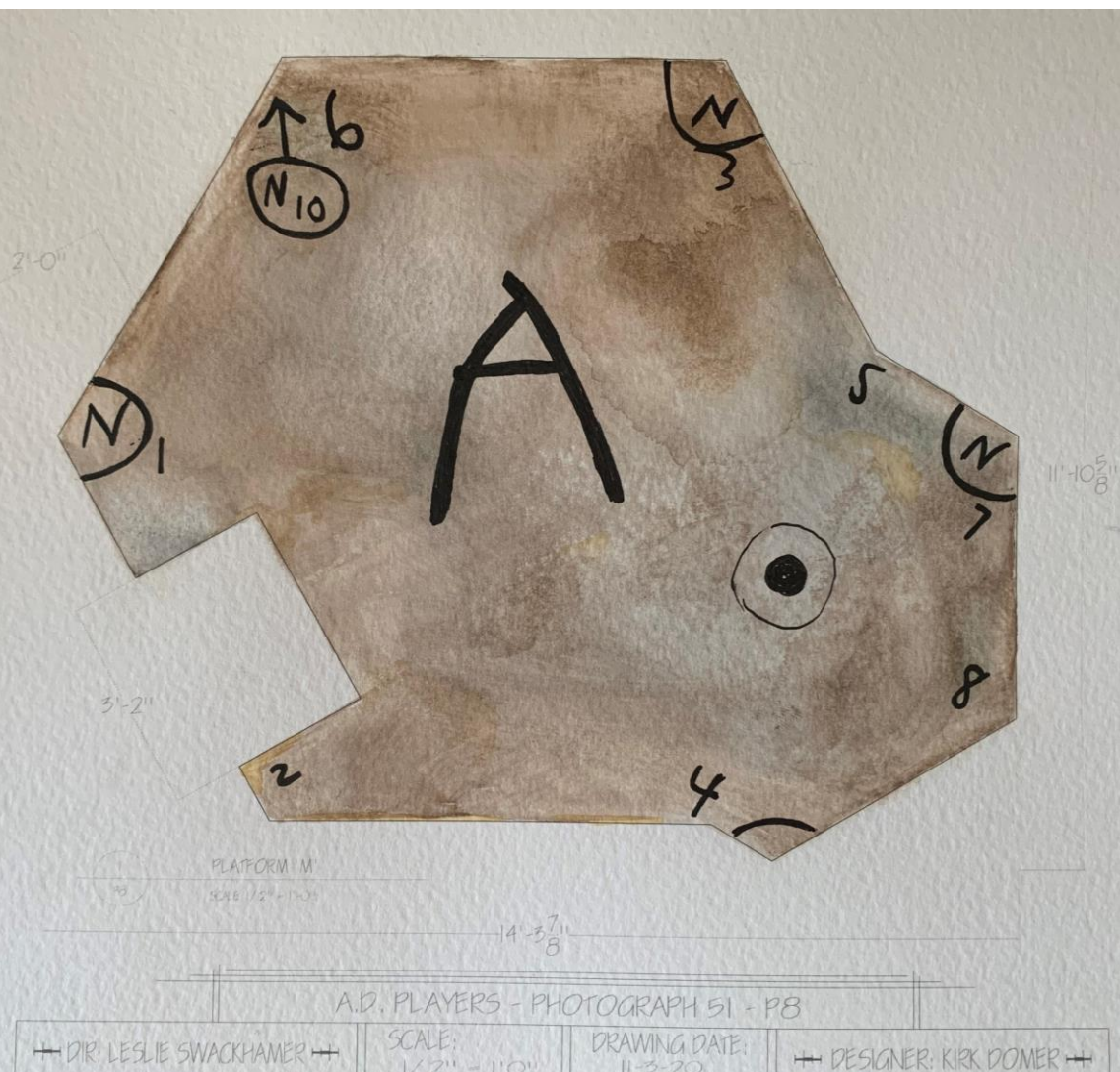

Elevations and Sample by Jordan House done with watercolor and ink

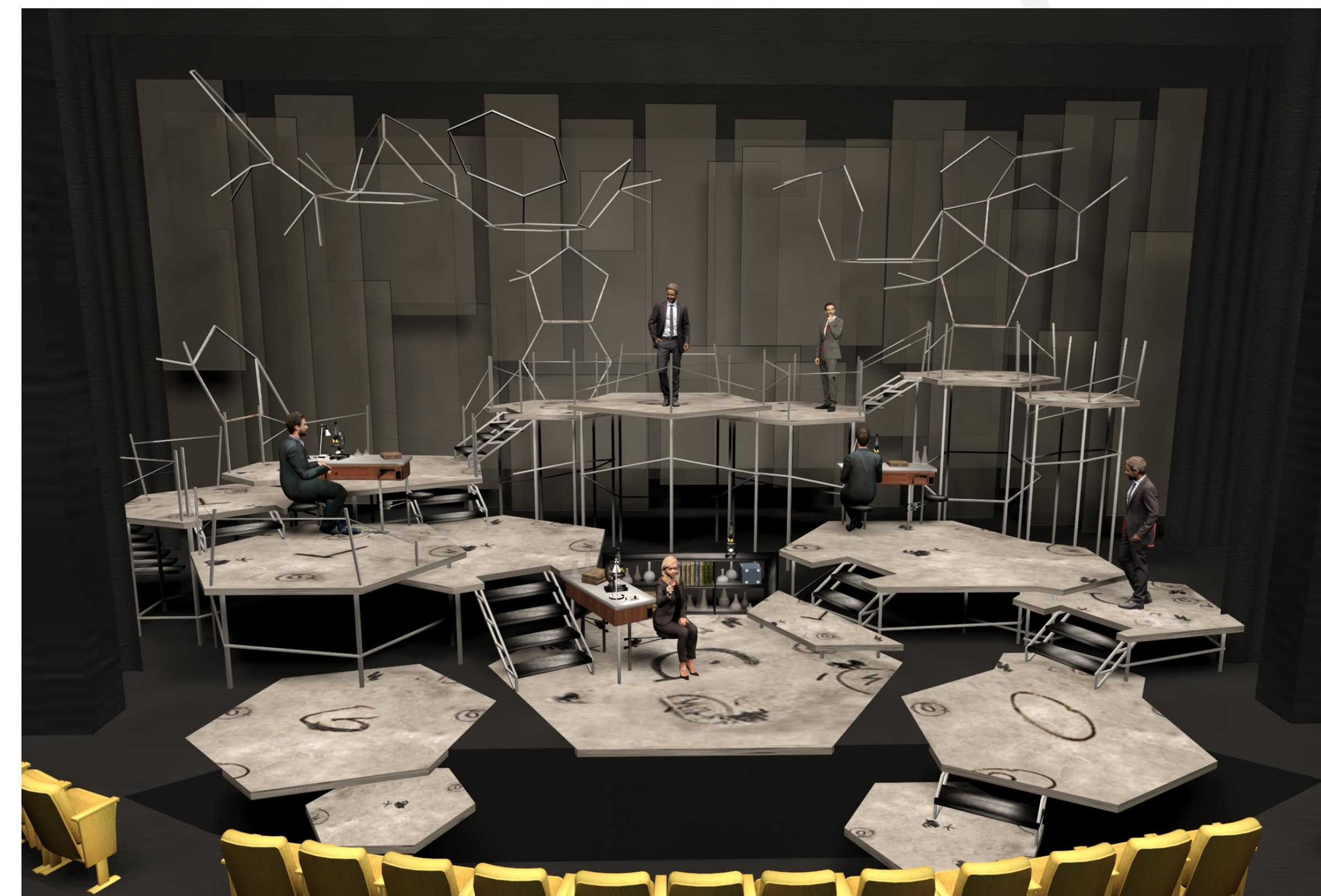
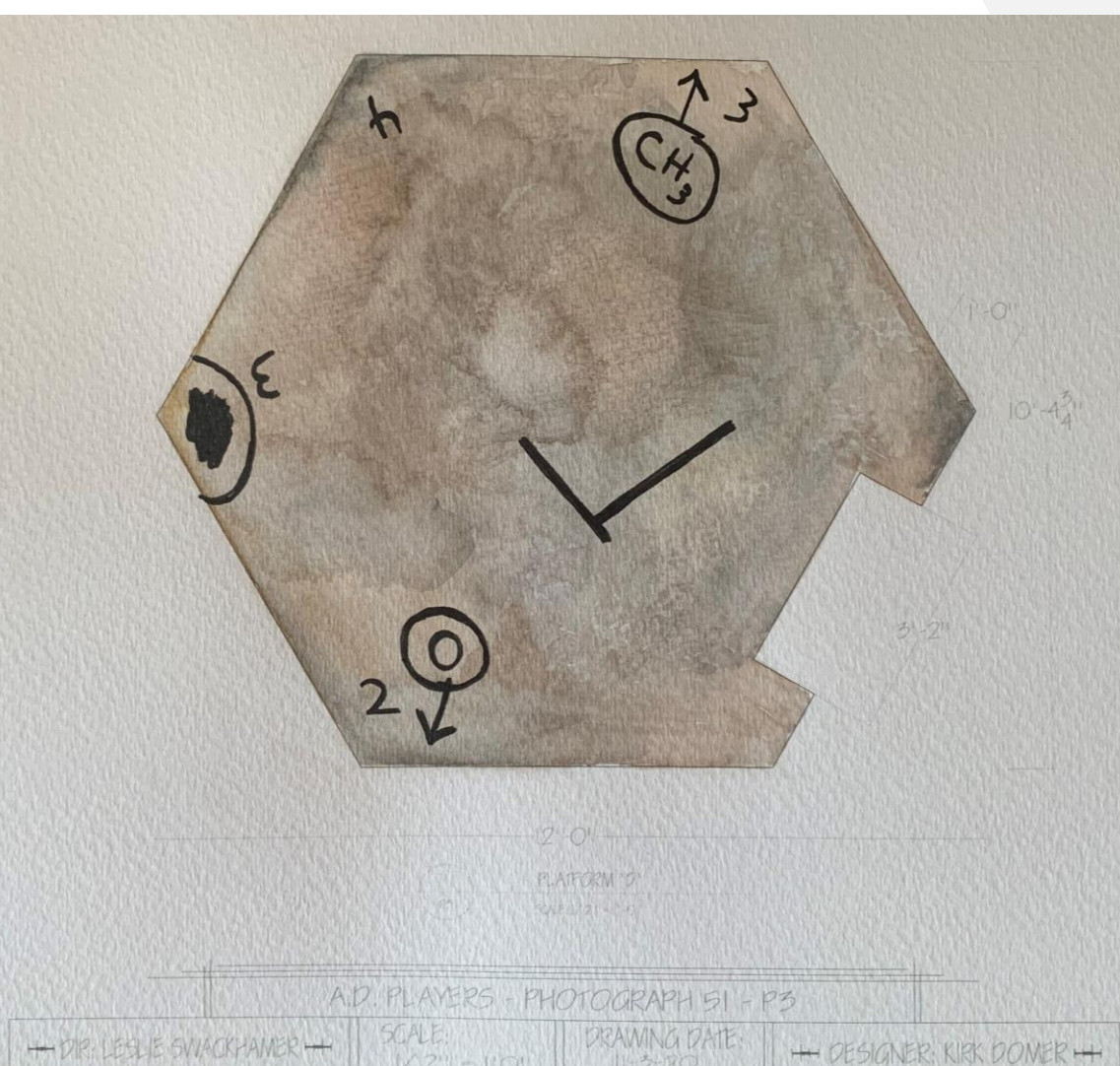

Rendering by Kirk A. Domer of set for *Photograph 51* at The George Theater

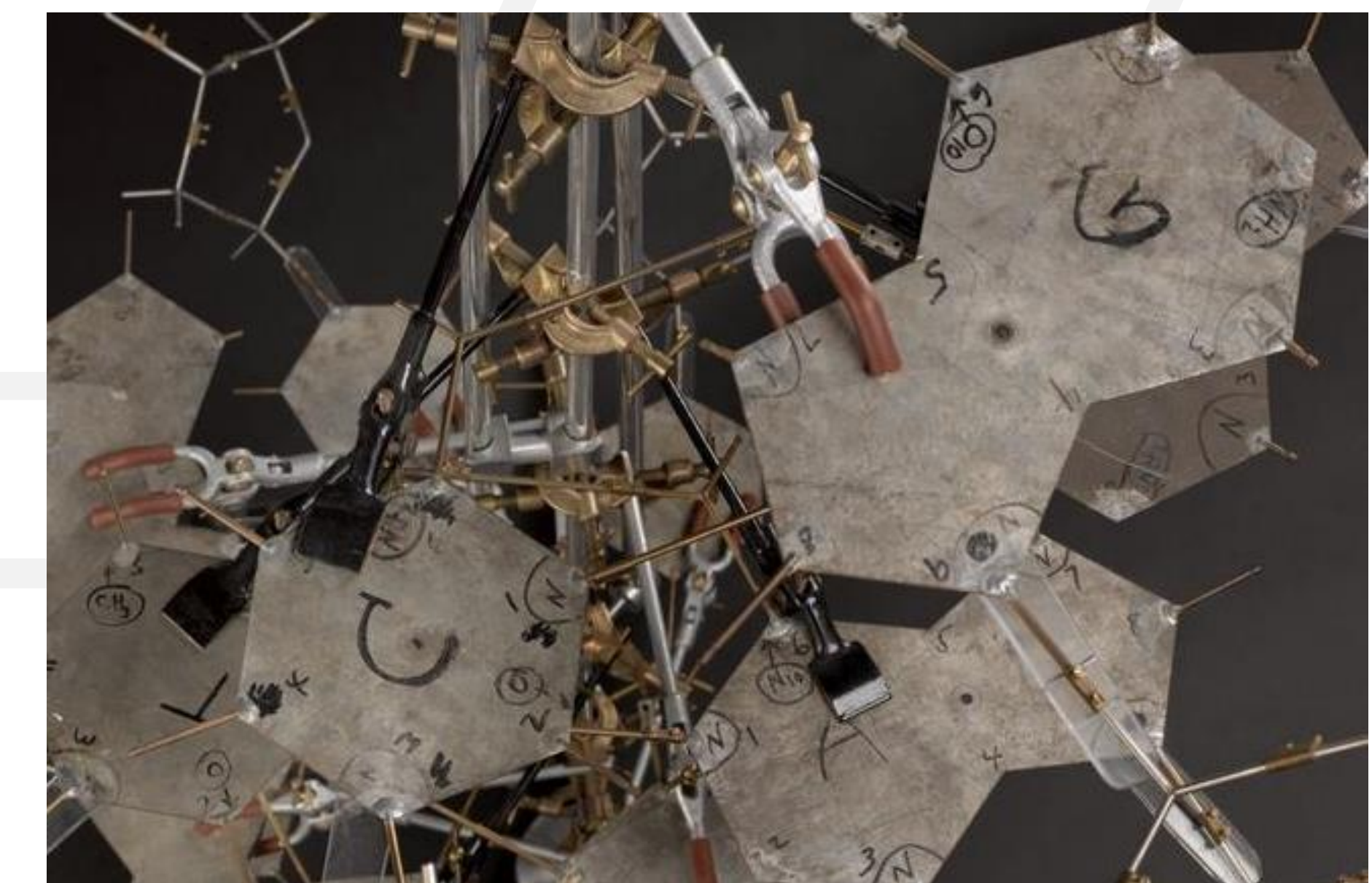

Research on original notations made on Watson and Crick's 1953 DNA Model

Project Abstract

For *Photograph 51*, a play by Anna Ziegler, I served as the assistant scene designer to Professor Kirk Domer, Professor of Scene Design at Michigan State University's Department of Theatre. The research revolved primarily **around learning and implementing painting techniques to create the appearance of faux metals exposed to the natural oils in the skin. Incorporating Rosco Scenic Paints, various lettering techniques were explored to recreate the original notations of James Watson and Francis Crick, the scientists credited with discovering and constructing their famous two-strand, or double-helix model for which the scene design was based.** While the final implementation of the scenery was not possible as the show was postponed due to the COVID-19 pandemic, professional-quality paint elevations and location/set dressing lists were finalized for future performance execution and valuable pieces for a student design portfolio.

Project Experience

- ❖ Learned how to replicate the appearance of faux metal exposed to natural oils of the skin through watercolors
- ❖ Learned to recreate the handwriting of scientists James Watson and Francis Crick
- ❖ Explored techniques of blending, layering and spattering to achieve the final look
- ❖ Explored the distinct differences in lettering and shapes created when writing with dominant and non-dominant hands
- ❖ Gained valuable professional experience and created quality pieces to add to a design portfolio
- ❖ Translated paint elevations into full scale samples to be used in future production with resident scenic painters

Production Team

Directed by Leslie Swackhamer
Costume Design by Kristina Miller
Lighting Design by Christina Gianelli
Property Design Shelby Bocker

Scenic Design by Kirk Domer
Sound Design by Peter Ton
Technical Direction by Michael Mullins
Asst. Scenic Design by Jordan House

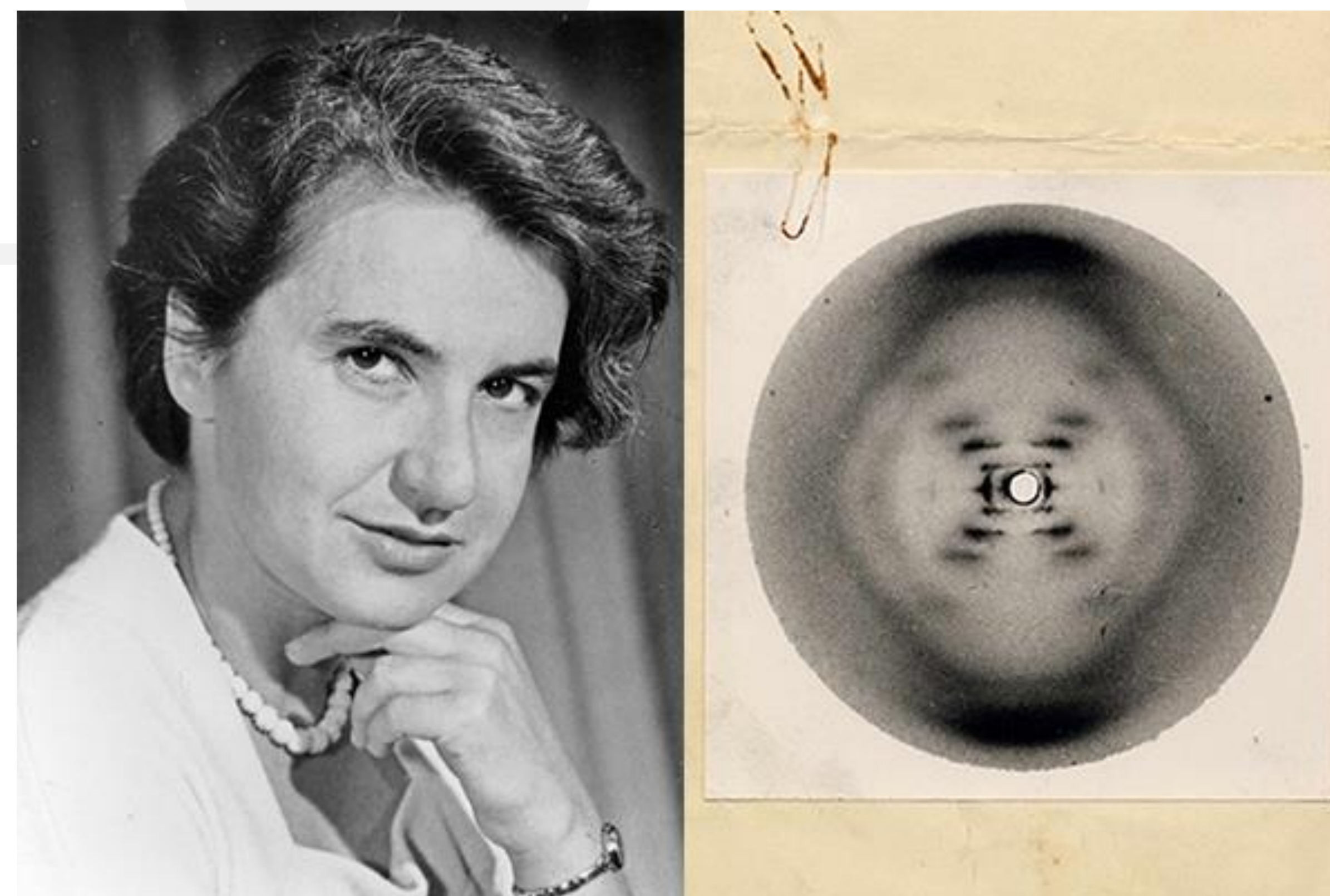

Rosalind Franklin and Photograph 51 of the double helix structure of DNA